

## SPECIFICATION

Technical data	Unit	GP56-S1-3.29	GP56-S1-3.93	GP56-S1-4.24	GP56-S1-5.08	GP56-S1-6.53	GP56-S1-7.71	GP56-S1-9.55
NUMBER OF STAGES		1-STAGE	1-STAGE	1-STAGE	1-STAGE	1-STAGE	1-STAGE	1-STAGE
EXACT RATIO		3,293	3,938	4,241	5,087	6,529	7,714	9,546
NOMINAL OUTPUT TORQUE								
FOR L10h = 5,000 h	Nm	16,81	22,63	15,43	10,15	13,70	6,76	3,74
MAX. OUTPUT TORQUE	Nm	33,62	45,26	30,86	20,30	27,40	13,52	7,48
RECOMMENDED INPUT SPEED	rpm	3500	3500	3500	3500	3500	3500	3500
MAX. INPUT SPEED	rpm	4658	5971	6589	8307	8988	10919	13000
EFFICIENCY	%	92	92	92	92	92	92	85
NOISE (n=3500 RPM, L = 1 M)	dB	≤ 55	≤ 55	≤ 55	≤ 55	≤ 55	≤ 55	≤ 55
BACKLASH WITH 2%								
OF THE RATED TORQUE	arcmin	≤ 30	≤ 30	≤ 30	≤ 30	≤ 30	≤ 30	≤ 30
LENGTH	mm	50,60	50,60	50,60	50,60	50,60	50,60	50,60
GEARBOX WEIGHT	kg	0,57	0,56	0,56	0,56	0,58	0,56	0,59

## CHARACTERISTICS

### Item

HOUSING MATERIAL	METAL
BEARING OUTPUT	BALL BEARINGS
OPERATING TEMPERATURE	-15°C + 90° C
MAX RADIAL LOAD (CENTER OF SHAFT)	650 N
MAX AXIAL LOAD	1641 N
PROTECTION CLASS	IP54

## PRODUCT COMBINATION

- BRUSHLESS MOTORS
    - 57BL
    - 57BLA
    - 57BLB
  - STEPPER MOTORS
    - 57SH
- AND OTHER COMBINATION ON REQUEST

## SPECIAL SOLUTION

- HIGH RADIAL LOAD
- LOW NOISE
- OTHER RATIOS ON REQUEST
- ROUND FLANGES



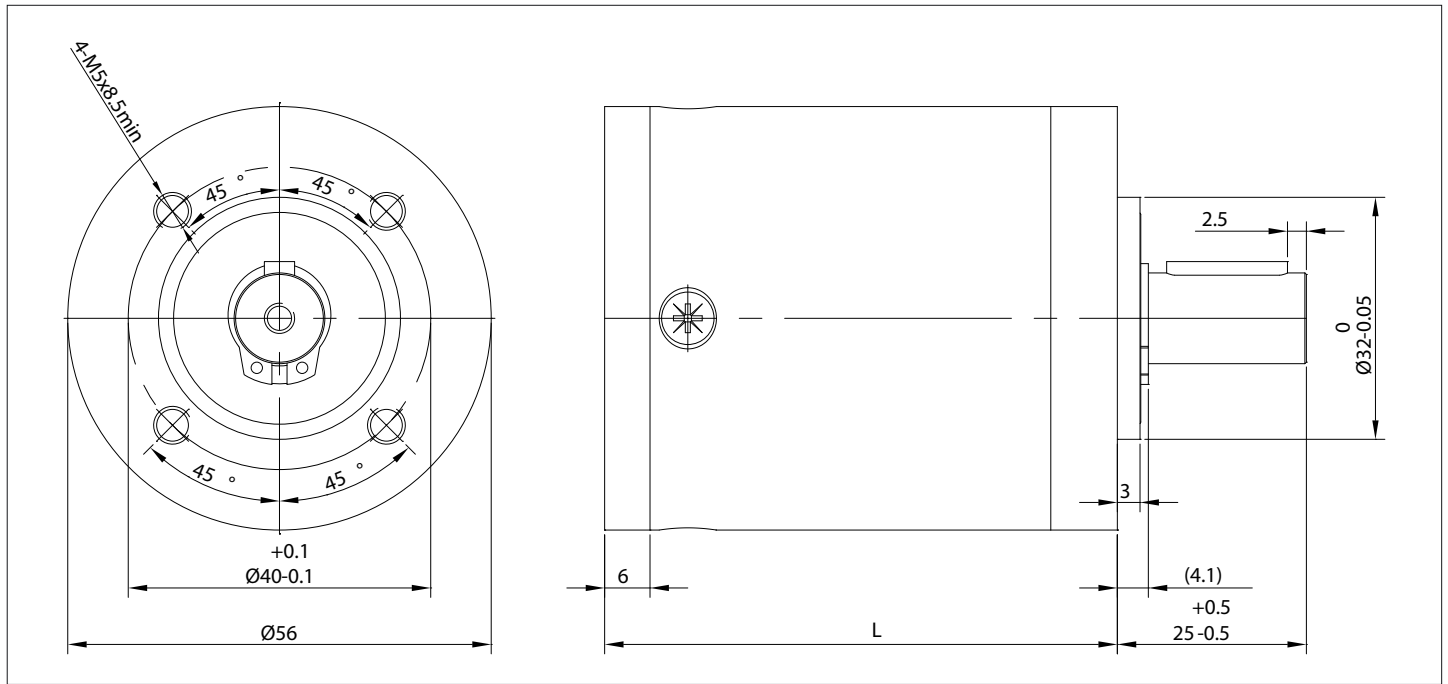

## SPECIFICATION

Technical data	Unit	GP56-S2-10.84	GP56-S2-15.51	GP56-S2-20.03	GP56-S2-25.71	GP56-S2-32.69	GP56-S2-42.63	GP56-S2-62.33
NUMBER OF STAGES		2-STAGES	2-STAGES	2-STAGES	2-STAGES	2-STAGES	2-STAGES	2-STAGES
EXACT RATIO		10,842	15,504	20,030	25,710	32,718	42,633	62,326
NOMINAL OUTPUT TORQUE FOR L10h = 5,000 h	Nm	20,06	25,53	25,93	26,36	22,36	18,44	19,26
MAX. OUTPUT TORQUE	Nm	40,12	51,06	51,86	52,72	44,72	36,88	38,52
RECOMMENDED INPUT SPEED	rpm	3500	3500	3500	3500	3500	3500	3500
MAX. INPUT SPEED	rpm	4658	5968	8307	8992	10919	8992	13000
EFFICIENCY	%	85	85	85	85	85	85	85
NOISE (N=3500 RPM, L = 1 M)	dB	$\leq 55$	$\leq 55$	$\leq 55$	$\leq 55$	$\leq 55$	$\leq 55$	$\leq 55$
BACKLASH WITH 2% OF THE RATED TORQUE	arcmin	$\leq 30$	$\leq 30$	$\leq 30$	$\leq 30$	$\leq 30$	$\leq 30$	$\leq 30$
LENGTH	mm	67,80	67,80	67,80	67,80	67,80	67,80	67,80
GEARBOX WEIGHT	kg	0,80	0,84	0,80	0,80	0,80	0,80	0,82

## CHARACTERISTICS

Item	
HOUSING MATERIAL	METAL
BEARING OUTPUT	BALL BEARINGS
OPERATING TEMPERATURE	$-15^\circ\text{C} + 90^\circ\text{C}$
MAX RADIAL LOAD (CENTER OF SHAFT)	650 N
MAX AXIAL LOAD	1641 N
PROTECTION CLASS	IP54

## PRODUCT COMBINATION

- BRUSHLESS MOTORS
    - 57BL
    - 57BLA
    - 57BLB
  - STEPPER MOTORS
    - 57SH
- AND OTHER COMBINATION ON REQUEST

## SPECIAL SOLUTION

- HIGH RADIAL LOAD
- LOW NOISE
- OTHER RATIOS ON REQUEST
- ROUND FLANGES

