

Brushed DC Coreless Motor 16DC25P-G

Ø 16mm - 4,8mNm

Graphite brushes

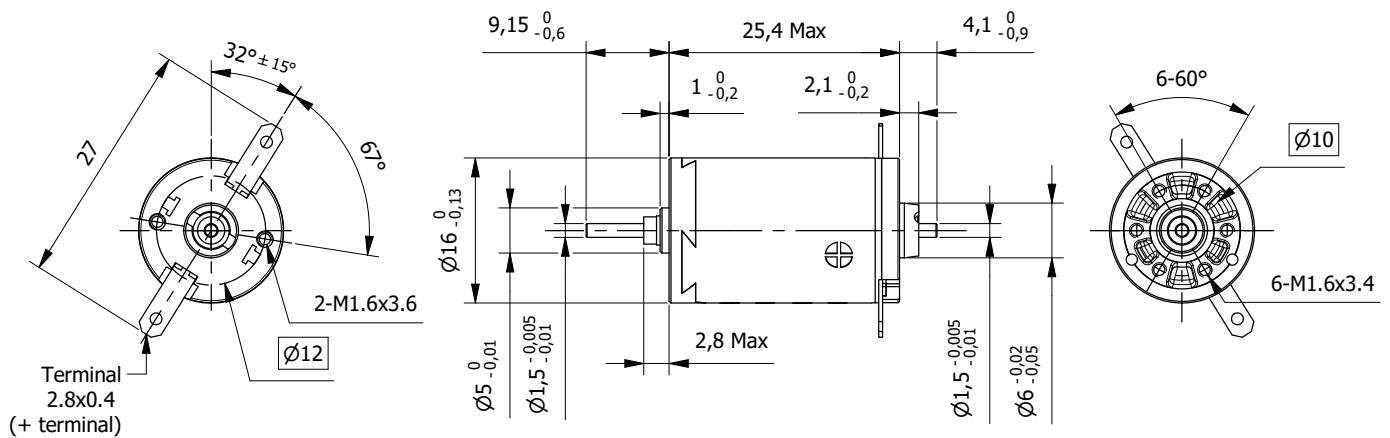

Product also available with ball bearings

Specification		...6702	...6211	...6537	
1	Rated Voltage	V	6	12	24
2	Rated Speed	rpm	6770	6200	6580
3	Rated Torque	mNm	3,71	4,31	4,76
4	Stall Torque	mNm	12,1	11,9	14,4
5	Torque Constant	mNm/A	5,62	11,2	22,5
6	Motor Regulation	$10^3/Nms$	88,3	90,9	74,1
7	Rated Current	A	0,72	0,413	0,227
8	Stall Current	A	2,15	1,05	0,64
9	No-load Current	mA	67,3	33,6	16,8
10	No-load Speed	rpm	9870	9860	9920
11	Line to Line Resistance	Ω	2,79	11,4	37,5
12	Line to Line Inductance	mH	0,086	0,343	1,37
13	Rotor Inertia	gcm ²	1	0,993	1,16
14	Max. Efficiency	%	68	68	71
15	Mechanical Time Constant	ms	8,85	8,92	8,57
16	Length (L)	mm	25,4	25,4	25,4
17	Weight	g	23,1	23,1	23,1

Characteristics	
Item	
Ambient Temperature Sleeve bearings	-30°C to +85°C
Max. Winding Temperature	+125°C
Max. Speed	11000rpm
Radial play	0,012mm
Axial play	0,05 to 0,15mm
Max. Radial force (5mm from flange)	1,4N
Max. Axial force	0,8N
Max. Force for Press fit	35N

Standard Combination	
Gearbox	
16GPS	
* other options on request	

Operating range: Winding 24V

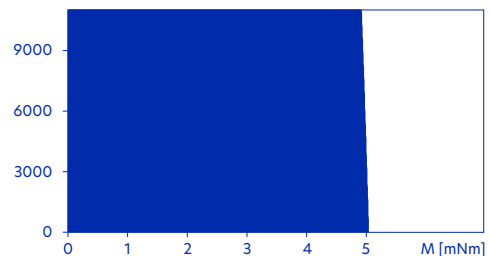

- Continuous operation
- Continuous operation with reduced Line to line Resistance (50%)
- Intermittent operation

Brushed DC Coreless Motor 16DC26N-PM

Precious Metal brushes

Ø 16mm - 5,4mNm

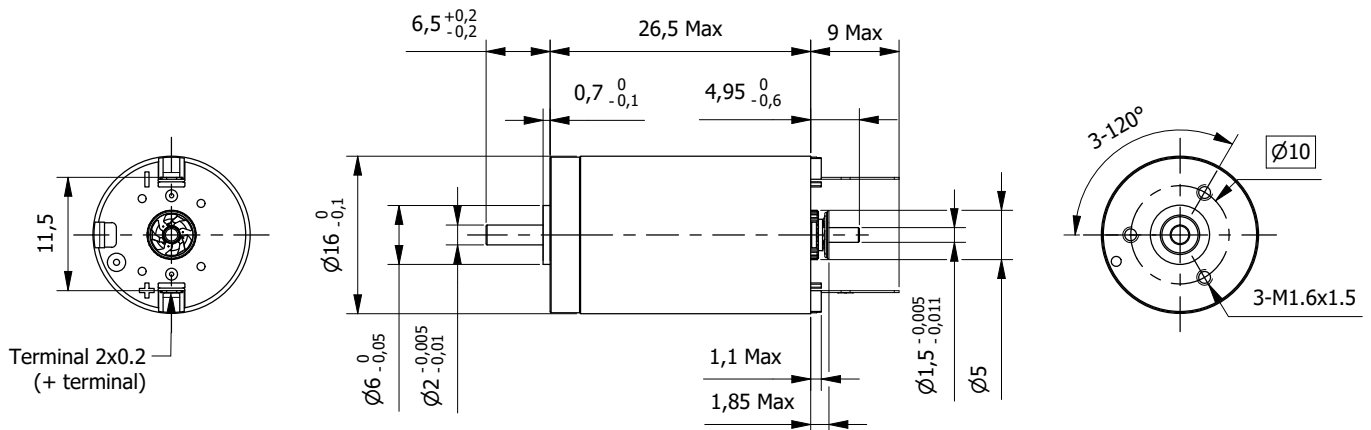

Product also available with ball bearings

Specification		...3301	...3704	...3319	...3283	
1	Rated Voltage	V	3	6	12	24
2	Rated Speed	rpm	3350	3760	3320	3200
3	Rated Torque	mNm	5,15	5,36	5,19	4,99
4	Stall Torque	mNm	11,1	12,6	11,2	10,4
5	Torque Constant	mNm/A	4,45	8,53	18	36
6	Motor Regulation	10 ³ /Nms	60,6	55,8	59,3	64,1
7	Rated Current	A	1,2	0,65	0,299	0,144
8	Stall Current	A	2,49	1,48	0,624	0,289
9	No-load Current	mA	44,6	23,4	11	5,51
10	No-load Speed	rpm	6320	6610	6260	6250
11	Line to Line Resistance	Ω	1,2	4,06	19,2	83,1
12	Line to Line Inductance	mH	0,036	0,131	0,581	2,32
13	Rotor Inertia	gcm ²	1	1,08	1,03	0,96
14	Max. Efficiency	%	75	77	75	74
15	Mechanical Time Constant	ms	6,09	6,05	6,11	6,17
16	Length (L)	mm	26,5	26,5	26,5	26,5
17	Weight	g	26	26	26	26

Characteristics	
Item	
Ambient Temperature Sleeve bearings	-30°C to +85°C
Max. Winding Temperature	+100°C
Max. Speed	8680rpm
Radial play	0,015mm
Axial play	0 to 0,2mm
Max. Radial force (5mm from flange)	2N
Max. Axial force	0,1N
Max. Force for Press fit	60N

Standard Combination	
Gearbox	16GPS
* other options on request	

Operating range: Winding 12V

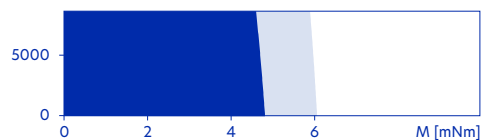

- Continuous operation
- Continuous operation with reduced Line to line Resistance (50%)
- Intermittent operation

Brushed DC Coreless Motor 16DC26N-G

Graphite brushes

Ø 16mm - 5,4mNm

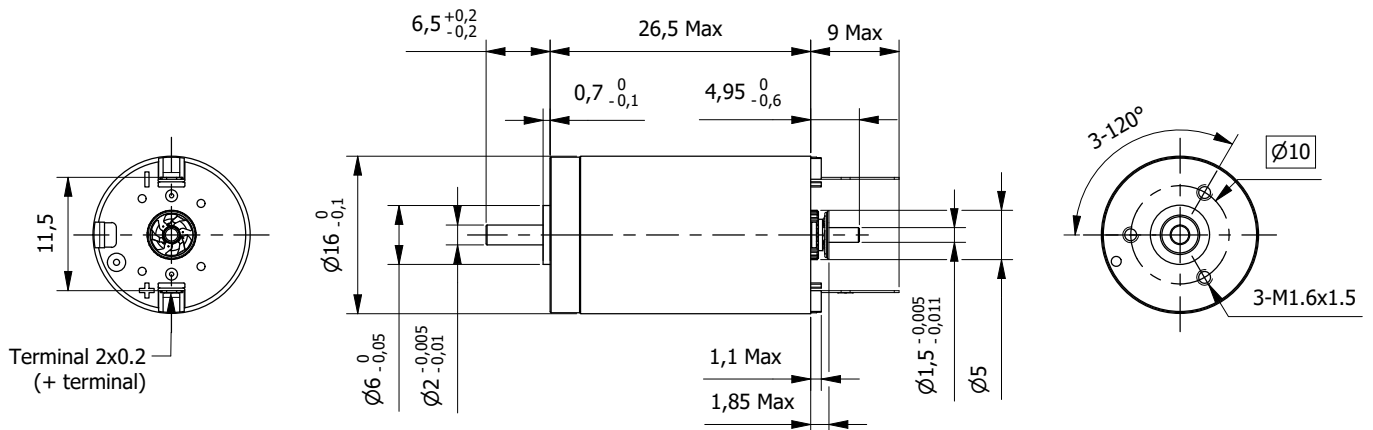

Product also available with ball bearings

Specification		...9401	...9804	...9419	
1	Rated Voltage	V	6	12	24
2	Rated Speed	rpm	9400	9850	9430
3	Rated Torque	mNm	5,45	5,36	5,43
4	Stall Torque	mNm	21,3	22,6	21,7
5	Torque Constant	mNm/A	4,45	8,53	17,8
6	Motor Regulation	10 ³ /Nms	63,1	62,3	62,2
7	Rated Current	A	1,28	0,662	0,321
8	Stall Current	A	4,79	2,65	1,22
9	No-load Current	mA	63,9	35,4	16,8
10	No-load Speed	rpm	12700	13200	12700
11	Line to Line Resistance	Ω	1,25	4,53	19,7
12	Line to Line Inductance	mH	0,036	0,131	0,569
13	Rotor Inertia	gcm ²	1	1,08	1,02
14	Max. Efficiency	%	78	76	78
15	Mechanical Time Constant	ms	6,35	6,74	6,32
16	Length (L)	mm	26,5	26,5	26,5
17	Weight	g	26	26	26

Characteristics	
Item	
Ambient Temperature Sleeve bearings	-30°C to +100°C
Max. Winding Temperature	+125°C
Max. Speed	17000rpm
Radial play	0,015mm
Axial play	0 to 0,2mm
Max. Radial force (5mm from flange)	2N
Max. Axial force	0,1N
Max. Force for Press fit	60N

Standard Combination	
Gearbox	
16GPS	
* other options on request	

Operating range: Winding 12V

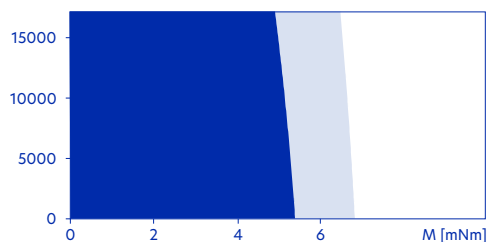

- Continuous operation
- Continuous operation with reduced Line to line Resistance (50%)
- Intermittent operation

Brushed DC Coreless Motor 16DC40N-PM

Precious Metal brushes

Ø 16mm - 10,8mNm

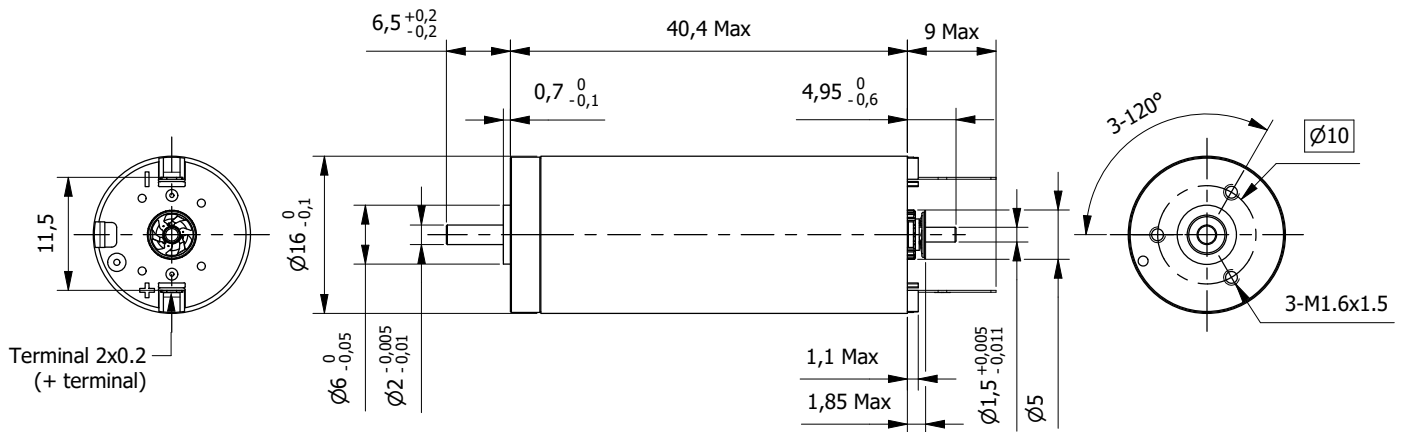

Product also available with ball bearings

Specification		...5403	...4901	...4405	...4622	
1	Rated Voltage	V	3	6	12	24
2	Rated Speed	rpm	5450	4920	4490	4630
3	Rated Torque	mNm	5,06	10	10,8	10,7
4	Stall Torque	mNm	34,4	39,3	36,6	36,6
5	Torque Constant	mNm/A	4,44	8,59	17,8	34,7
6	Motor Regulation	10 ³ /Nms	19,7	17,8	18,4	18,9
7	Rated Current	A	1,2	1,2	0,625	0,316
8	Stall Current	A	7,73	4,57	2,06	1,06
9	No-load Current	mA	62,5	32,6	15,6	8,05
10	No-load Speed	rpm	6400	6620	6400	6560
11	Line to Line Resistance	Ω	0,388	1,31	5,82	22,7
12	Line to Line Inductance	mH	0,026	0,096	0,411	1,56
13	Rotor Inertia	gcm ²	2,18	2,36	2,28	2,23
14	Max. Efficiency	%	83	84	83	83
15	Mechanical Time Constant	ms	4,29	4,2	4,19	4,23
16	Length (L)	mm	40,4	40,4	40,4	40,4
17	Weight	g	42	42	42	42

Characteristics	
Item	
Ambient Temperature Sleeve bearings	-30°C to +85°C
Max. Winding Temperature	+100°C
Max. Speed	8680rpm
Radial play	0,015mm
Axial play	0 to 0,2mm
Max. Radial force (5mm from flange)	2N
Max. Axial force	0,1N
Max. Force for Press fit	60N

Standard Combination	
Gearbox	
16GPS	
* other options on request	

Operating range: Winding 9V

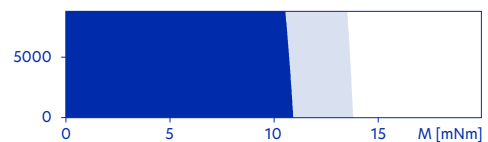

- Continuous operation
- Continuous operation with reduced Line to line Resistance (50%)
- Intermittent operation

Brushed DC Coreless Motor 16DC40N-G

Graphite brushes

Ø 16mm - 11,3mNm

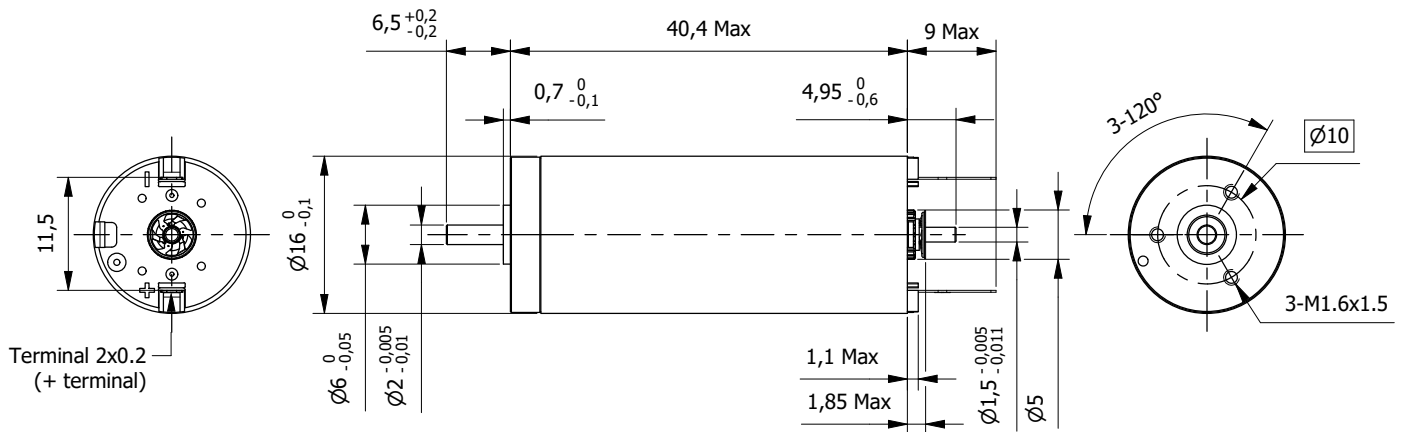

Product also available with ball bearings

Specification		...11004	...10701	...10606	
1	Rated Voltage	V	6	12	24
2	Rated Speed	rpm	11000	10700	10600
3	Rated Torque	mNm	8,58	10,4	11,3
4	Stall Torque	mNm	61,8	63,3	68,5
5	Torque Constant	mNm/A	4,44	8,59	17,8
6	Motor Regulation	10 ³ /Nms	21,9	22,1	19,7
7	Rated Current	A	2	1,24	0,651
8	Stall Current	A	13,9	7,37	3,85
9	No-load Current	mA	73,5	38,6	18,4
10	No-load Speed	rpm	12800	13200	12800
11	Line to Line Resistance	Ω	0,431	1,63	6,23
12	Line to Line Inductance	mH	0,026	0,096	0,411
13	Rotor Inertia	gcm ²	2,18	2,36	2,28
14	Max. Efficiency	%	85	83	86
15	Mechanical Time Constant	ms	4,77	5,21	4,48
16	Length (L)	mm	40,4	40,4	40,4
17	Weight	g	42	42	42

Characteristics	
Item	
Ambient Temperature Sleeve bearings	-30°C to +100°C
Max. Winding Temperature	+125°C
Max. Speed	15000rpm
Radial play	0,015mm
Axial play	0 to 0,2mm
Max. Radial force (5mm from flange)	2N
Max. Axial force	0,1N
Max. Force for Press fit	60N

Standard Combination	
Gearbox	16GPS
* other options on request	

Operating range: Winding 12V

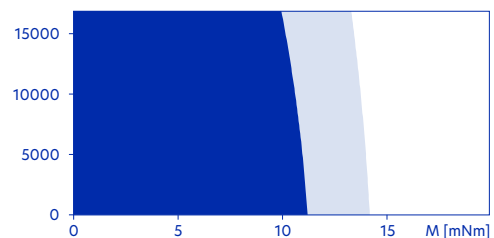

- Continuous operation
- Continuous operation with reduced Line to line Resistance (50%)
- Intermittent operation